

No 115

No 1263

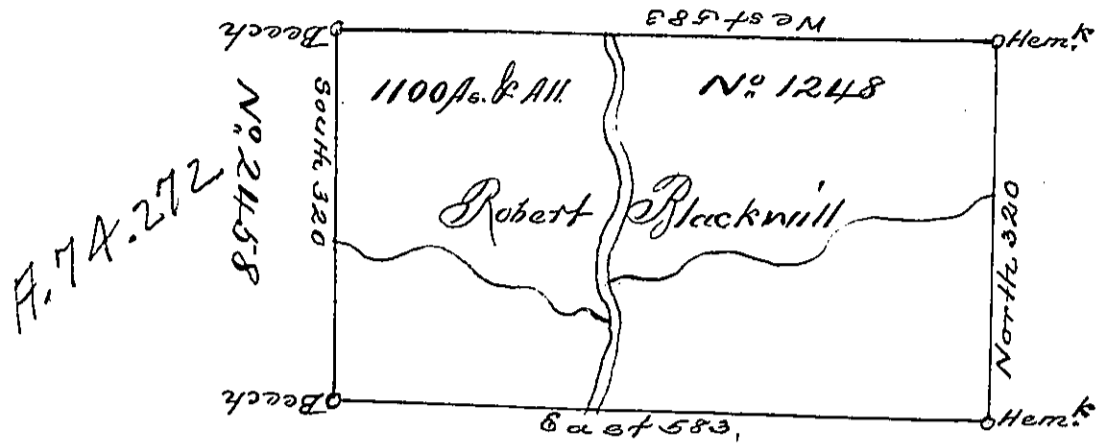

#1199  
A-30-274

#1198  
C-225-154

Situate on the Portage Branch of Sinnamahoning Creek one Mile North of a big Chick  
 Lick in North<sup>d</sup> County containing 1100 Acres and the usual allowance for Roads &c  
 Surveyed July 16<sup>th</sup> 1793 for Robert Blackwill in pursuance of a warrant No 1248  
 bearing date the 26<sup>th</sup> day of April 1792.

Daniel Brodhead Esq  
 S. G.

John Lanan Esq

IN TESTIMONY that the above is a copy of the original remaining on file in the  
 Department of Internal Affairs of Pennsylvania, made con-  
 formably to an Act of Assembly approved the 16th day of  
 February, 1833, I have hereunto set my Hand and caused  
 the Seal of said Department to be affixed at Harrisburg, this  
second day of April 1895,

Grace P. Brown  
 Secretary of Internal Affairs.